



INSTRUCTION BULLETIN

No. 340855
Machine: M20 / T20
Published: 04-2007
Rev. 00

NOTE: DO NOT DISCARD the Parts List from the Instruction Bulletin. Place the Parts List in the appropriate place in the machine manual for future reference. Retaining the Parts List will make it easier to reorder individual parts and will save the cost of ordering an entire kit.

NOTE: Numbers in parenthesis () are reference numbers for parts listed in Bill of Materials.

Installation instructions for **kit number 9003478**

SYNOPSIS:

This kit contains the parts needed to install a squeegee lift replacement kit on M20/T20 machines. Please follow step-by-step instructions.

SPECIAL TOOLS / CONSIDERATIONS: NONE

(Estimated time to complete: 1.5 hours)

PREPARATION:

NOTE: Step 1 through Step 3 of this section can be used to prepare both the M20 and T20 for kit installation.

1. Park the machine on a clean level surface, raise the squeegee, shut off the machine, and set the parking brake.

FOR SAFETY: Before leaving or servicing machine, stop on a level surface, set parking brake, turn off machine, and remove key.

2. Disconnect the vacuum hose from the squeegee and remove the squeegee from the machine. Set the squeegee and mounting knobs/hardware aside. Refer to Fig. 1.

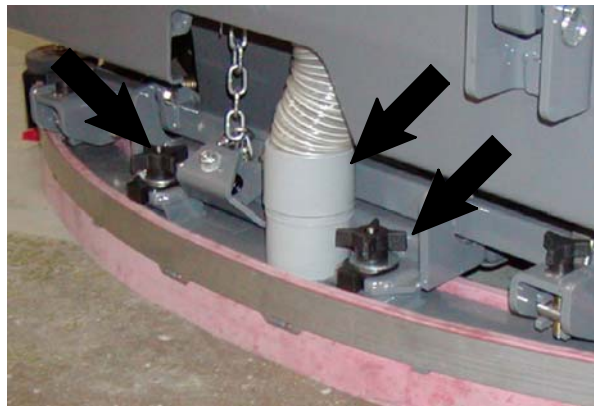

FIG. 1

3. Start the machine, lower the squeegee, turn off the machine, and remove the key.

4. **M20 Machines Only:** Disconnect the chain from the lift pin weldment attached to the squeegee cross member. Discard the mounting hardware. Refer to Fig. 2.



FIG. 2

5. **M20 Machines Only:** Disconnect the eye bolts attached to the extension springs from both sides of the machine. Set removed hardware aside. Refer to Fig. 3.
6. Remove the hardware holding the left and right angle to the squeegee cross member and remove the squeegee cross member from the machine. Set removed hardware aside. Refer to Fig. 3.

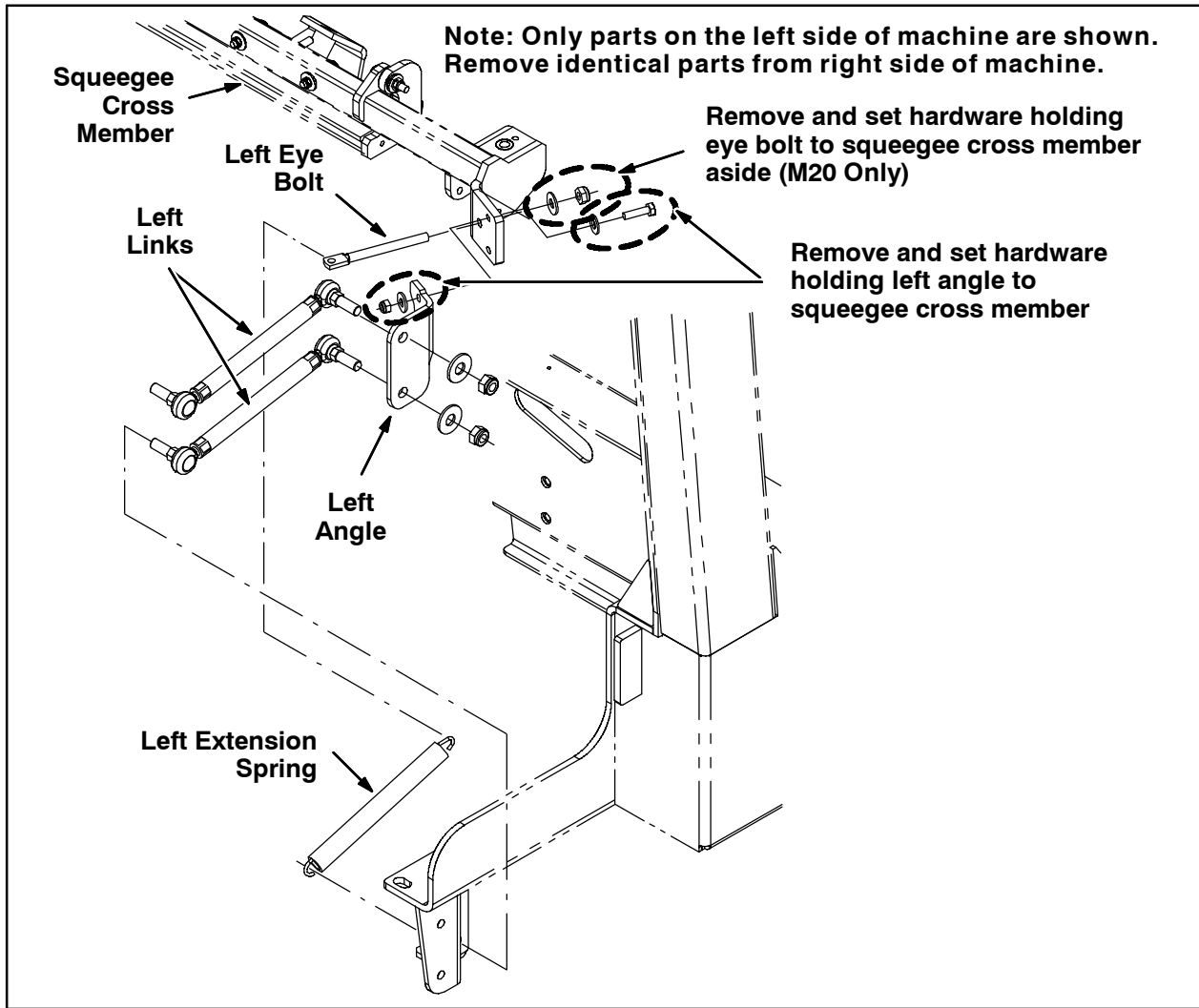

FIG. 3

INSTALLATION:

1. Remove the lift pin weldment from the squeegee cross member. Discard the lift pin weldment and all hardware. Refer to Fig. 4.

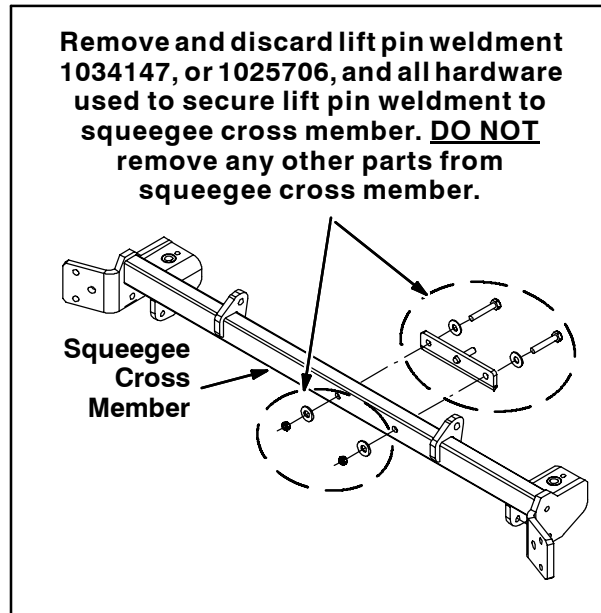

FIG. 4

2. Place the new squeegee lift angle (1) onto the side the squeegee cross member opposite of where the lift angle is mounted align the outer holes in the lift angle with the holes in the squeegee cross member, and use the lift angle as a template to drill a 3/8" hole through the center hole in the lift angle and through the squeegee cross member. Refer to Fig 5.
3. Use two hex screws (4), four flat washers (2), and two hex nuts (3) to install the squeegee lift angle (1) onto the squeegee cross member. Refer to Fig. 5.
4. **M20 Machines Only (These parts can be discarded if installing kit on a T20 machine):** Slide a flat washer (2) onto the hex screw (5) and insert the hex screw through the new hole and the existing hole in the squeegee cross member and the squeegee lift angle (1). Refer to Fig. 5.
5. Reinstall the squeegee cross member onto the machine. If working on an M20 machine, be sure the hex screw (5) and flat washer (2) installed in the previous step remain in place in the squeegee cross member and squeegee lift angle (1). Refer to Fig. 3 and Fig. 5.
6. **M20 Machines Only (These parts can be discarded if installing kit on a T20 machine. The T20 is not equipped with this chain):** Use a flat washer (2) and hex nut (3) to attach the chain to the hex screw (5). Refer to Fig. 2 and Fig. 5.
7. Reinstall the squeegee onto the machine. Refer to Fig. 1

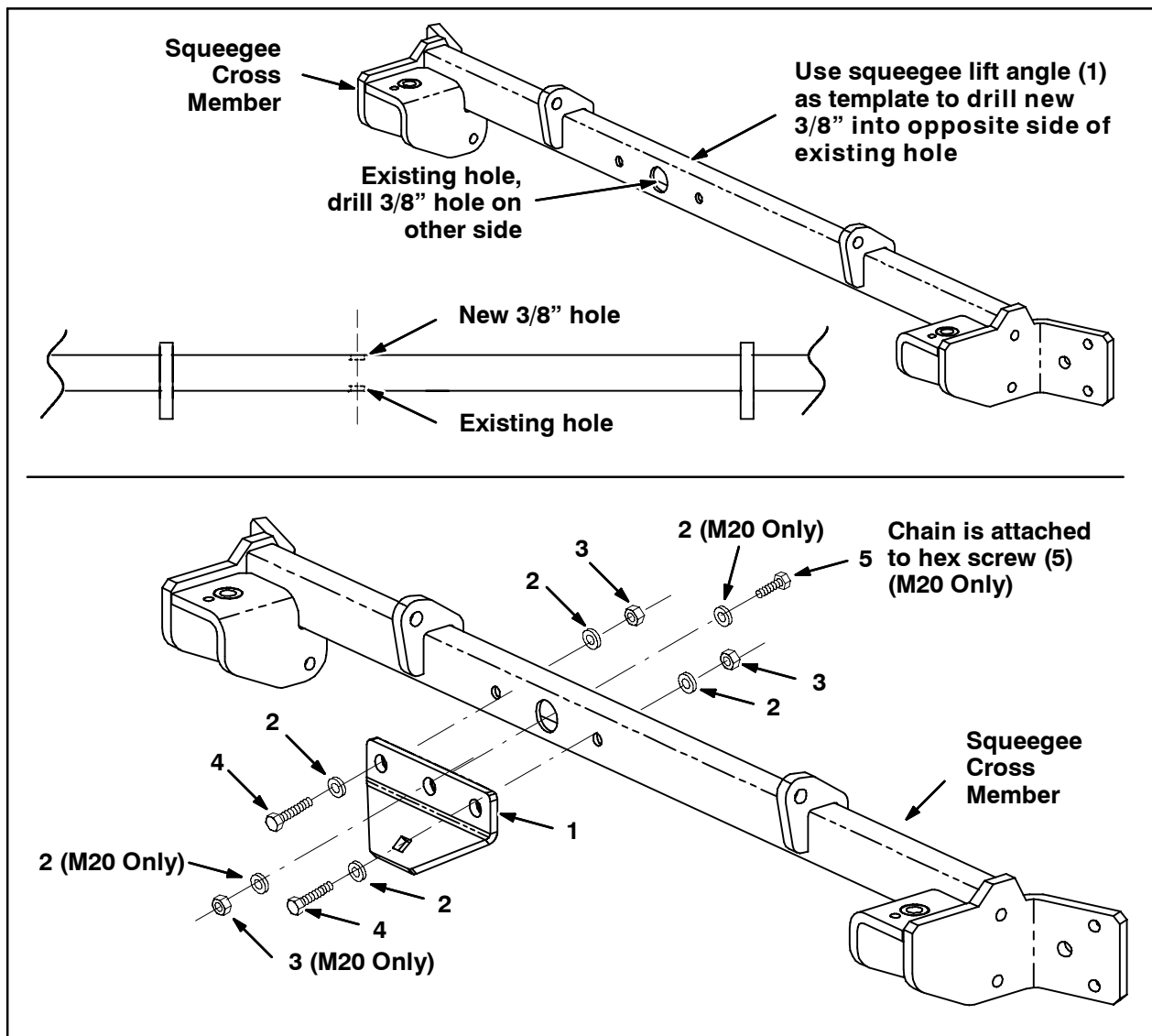

FIG. 5

8. Level the rear squeegee and check/adjust the rear squeegee blade deflection. Refer to LEVELING THE REAR SQUEEGEE and ADJUSTING THE REAR SQUEEGEE BLADE DEFLECTION in the Maintenance section of the Operators manual for instructions how to level the rear squeegee and adjust rear squeegee blade deflection.
9. Operate the machine and check the squeegee level and squeegee blade deflection. Make adjustments as necessary.

Bill of Materials for Lift Kit, Sqge, Replmt-9003478

	Tennant			
	Ref.	Part No.	Description	Qty.
▽		9003478	Lift Kit, Sqge, Replmt	1
▲	1	1038192	Angle, Lift, Sqge	1
▲	2	01685	Washer, Flat, 0.38B 0.88D .08, SS	6
▲	3	08713	Nut, Hex, Lock, M8 X 1.25, NL, SS	3
▲	4	222505	Screw, Hex, M8 X 1.25 X 45, SS	2
▲	5	06957	Screw, Hex, M8 X 1.25 X 60, 8.8	1

TENNANT COMPANY
P. O. Box 1452
Minneapolis, MN 55440-1452